

HINKLEY

3 SPEED FAN & LIGHT REMOTE CONTROL INSTALLATION INSTRUCTIONS

Model: 980004

READ AND SAVE THESE INSTRUCTIONS

GENERAL INFORMATION

This wall remote control is designed to separately control your ceiling fan speed and light brightness.

- The fan button will control the fan speed. (Hi, Medium, Low)
- The light buttons will control the lights, brightness dimmer and off.
- The red indicator on the transmitter will light when the button is pressed.

NOTE: When installing the remote control, be sure your fan control or pull chain switch are in the "**HIGH SPEED**" position and the light control or switch is set to "**ON**".

INSTALLATION AND OPERATING INSTRUCTIONS

1. HANDHELD TRANSMITTER

NOTE: This unit is equipped with an automatically learned type remote control. There are no frequency switches on the receiver and transmitter; the receiver unit will automatically scan the frequency from the handheld remote if any changes are made. This unit has 65,000 different code combinations.

Remove the set screw on the back of transmitter, take out the battery cover. Insert the 3 volt battery (included) and make sure they are seated correctly in each recess with the Positive + sign facing up. When remove or insert the batteries, use a suitable screwdriver to loosen or tighten the screws and open the back cover. (Fig. A)

NOTE: To prevent damage to the transmitter, remove these batteries if not used for long periods of time (months).

WARNING: Chemical Burn Hazard. Keep batteries away from children.

This product contains a lithium button/coin cell battery. If a new or used lithium button/coin cell battery is swallowed or enters the body, it can cause severe internal burns and can lead to death in as little as 2 hours. Always completely secure the battery compartment. If the battery compartment does not close securely, stop using the product, remove the batteries, and keep it away from children. If you think batteries might have been swallowed or placed inside any part of the body, seek immediate medical attention.

The batteries shall be disposed of properly, including keeping them away from children; Even used cells may cause injury.

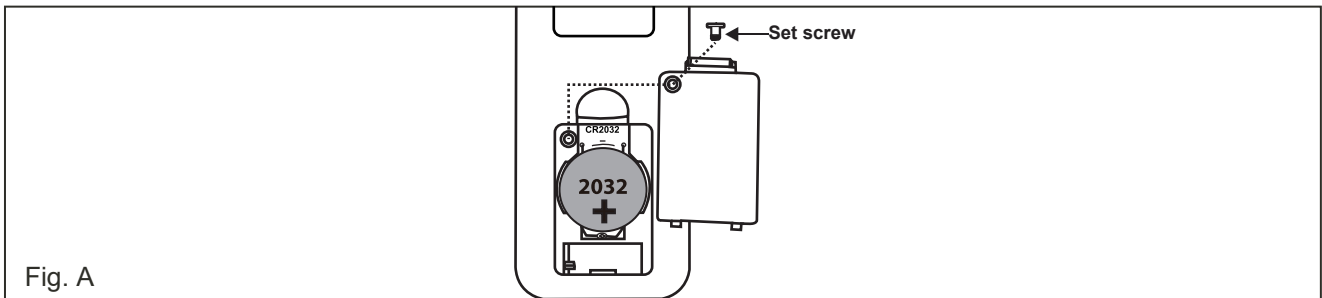

2. INSTALLING RECEIVER IN THE CEILING FAN

A. Safety precautions:

WARNING: HIGH VOLTAGE! Household electrical power can cause serious injury or death. Disconnect the source of electrical power to the ceiling fan by removing the fuse or switching off the circuit breaker.

B. Installing receiver in fan.:

- Remove the ceiling fan canopy from the mounting bracket.
- Disconnect the existing wiring between the ceiling fan and supply at the electrical junction box.
- Make the connections as follows, using the wire nuts supplied: (Fig. C)

CONNECT

TO

Green fan wire.....Bare supply wire
Black receiver wire (AC IN L).....Black supply wire
White receiver wire (AC IN N).....White supply wire
White receiver wire (TO MOTOR N).....White fan wire
Black receiver wire (TO MOTOR L).....Black fan wire
Blue receiver wire (FOR LIGHT).....Blue light wire

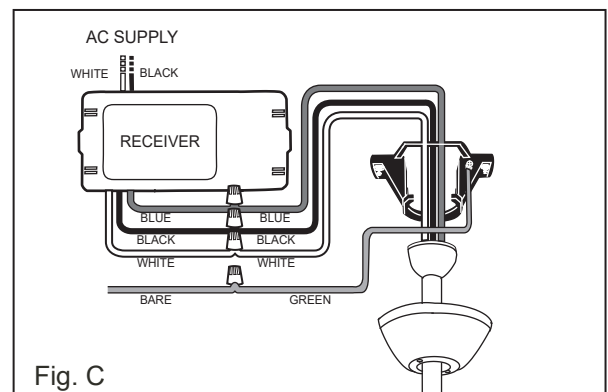
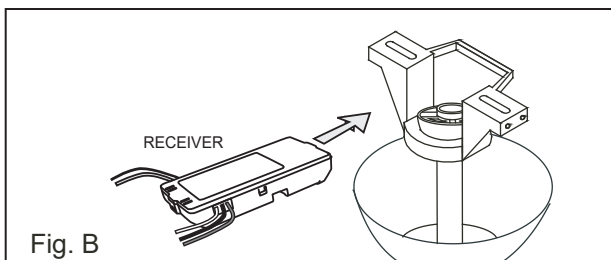

If other fan or supply wires are different color, have this unit installed by a qualified electrician.

- d. Push all connected wires up into junction box.
- e. Reinstall the canopy on the mounting bracket.
- f. Restore the electrical power.

3. REMOTE PAIRING PROCESS:

With the fan's power off, restore power to the fan. Press and hold "■" button for about 5 seconds and release. If optional light kit is installed, the light kit will flash twice and the signal light on the handheld remote will come on when the button is pressed. The fan has completed the pairing process with the handheld remote and is ready for use.

4. OPERATING TRANSMITTER:

A. H, M and L buttons: (Fig. D)

These three buttons are used to set the fan speed as follows:

- H= high speed
- M= medium speed
- L= low speed

B. ■ button:

This button turns the fan off.

C. The "☀" button:

The "☀" button turns the light ON or OFF and also controls the brightness setting. Press and hold the button to dim and brighten the light. Press and hold the button and release the button at desired brightness. The light key has an auto-resume, it will stay at the same brightness as the last time it was turned off.

D. "2H", "4H" and "8H" buttons:

Pressing the timer buttons will automatically turn fan off after 2, 4, or 8 hours.

Please note that the timer buttons is active **only** when the fan speeds turn **on**. the light is **not** included.

You can cancel the timer by pressing ■ button and re-start the fan speed.

NOTE: The distance between the transmitter and receiver should not be greater than 30 feet. For best performance.

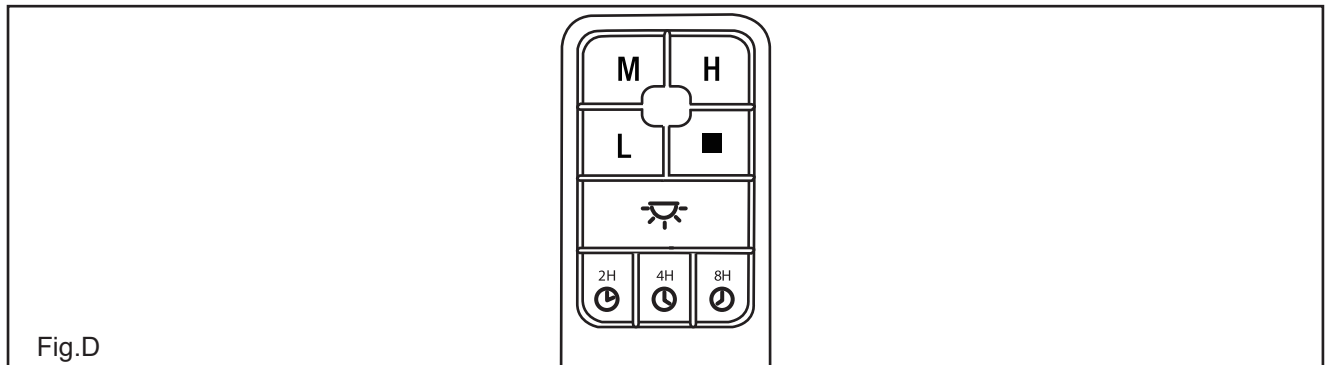

YOUR REMOTE NOW HAS FULL CONTROL OF THE FAN AND LIGHT.

5. TROUBLESHOOTING GUIDE

A. Fails to operate:

- a. Power to the receiver?
- b. Receiver wired correctly?
- c. Fan manual speed control in highest position?
- d. Light kit switch turned on?
- e. Code set at exact same position in both transmitter and receiver?

B. Won't operate at distance:

If transmitter operates the fan and the light kit when up close, but not a 30 feet away, try placing the black antenna wire higher; up through the ceiling, outside the junction box.

NOTICE!

Your ceiling fan and light kit assembly must meet the following requirements:

- 1. Do not use with solid state fans.
- 2. Electrical rating: 120V / 60 Hz
MAX. motor amps: 1.0 A
MAX. light watts: 250 W
(Incandescent only)

For Warranty Information please visit www.hinkley.com

SMART CEILING FAN WIFI REMOTE CONTROL

INSTALLATION & OPERATING INSTRUCTIONS

SMART PHONE install add device

1. Install with WIFI APP

- A. To enjoy all the potential of your new device, you will need to download the BOND HOME app, available on the Google Play Store and Apple App Store
- B. Use the QR code presented in Figure 1 to download the app, or you can download the app using below link. <http://bondhome.io/app>.



- C. After you download the app, register new account and password.

NOTE: Please keep this account property, you will use this account when you connect with you smart speaker.

- D. After you Log into the main page, you will see the "+ " on the right side of top space.

- E. You will see ADD a new device screen, and choose Smart by Bond. Then you could follow the config WiFi process to continue pairing.

- F. After the pairing process is complete you can control. the fan speed, light functions on the app.

2. Process to make the fan discoverable:

- A. Press and hold the "off" button for 5 seconds. The light will turn on and off to indicate discovery mode.

- B. Add a device per the instruction above.

