

HINKLEY

4 SPEED FAN & LIGHT REMOTE CONTROL WITH SMART RECEIVER INSTALLATION INSTRUCTIONS

Model: 980016

READ AND SAVE THESE INSTRUCTIONS

GENERAL INFORMATION

This remote control is designed to separately control your ceiling fan speed and light brightness.

- The fan button will control the fan speed. (1 - LOW, 2, 3, 4 - High)
- Select “D” or “O” in the frequency switches to control the light dimmer or ON/OFF function based on your light bulbs.
- The red indicator on the transmitter will light when the button is pressed.

INSTALLATION AND OPERATING INSTRUCTIONS

1. INSTALLING RECEIVER IN THE CEILING FAN

A. Safety precautions:

WARNING: HIGH VOLTAGE! Household electrical power can cause serious injury or death. Disconnect the power to the ceiling fan by removing the fuse or switching the power off at the circuit breaker.

B. Installing receiver in fan.:

1. Remove the ceiling fan canopy from the hanger bracket. (Fig. 1)
2. Disconnect the existing wiring between the ceiling fan and supply at the electrical junction box. (Fig. 1)
3. Lay the black antenna wire on top of the receiver, and put the receiver in the mounting bracket. (Fig. 1)
4. Make the connections as follows, using the wire nuts supplied: (Fig. 2)

a. Make wire connections from the fan to the receiver unit.

- Connect one BLACK wire from the fan to BLACK wire from the receiver.
- Connect one BLUE wire from the fan to BLUE wire from the receiver.
- Connect one WHITE wire from the fan to WHITE wire from the receiver.
- Connect one ORANGE wire from the fan to ORANGE wire from the receiver.
- Connect one GREEN wires from the fan to ground wire (green or bare copper) from the ceiling.

b. Make wire connections from the receiver to the ceiling.

- Connect one BLACK wire from the fan to BLACK wire from the ceiling.
- Connect one WHITE wire from the fan to WHITE wire from the ceiling.

If there are wires with different colors, have this unit installed by a qualified electrician.

5. Push all connected wires up into junction box.
6. Reinstall the canopy on the hanger bracket.
7. Restore the electrical power.

NOTE: When installing the remote control, be sure the light switch is set to the ON position.

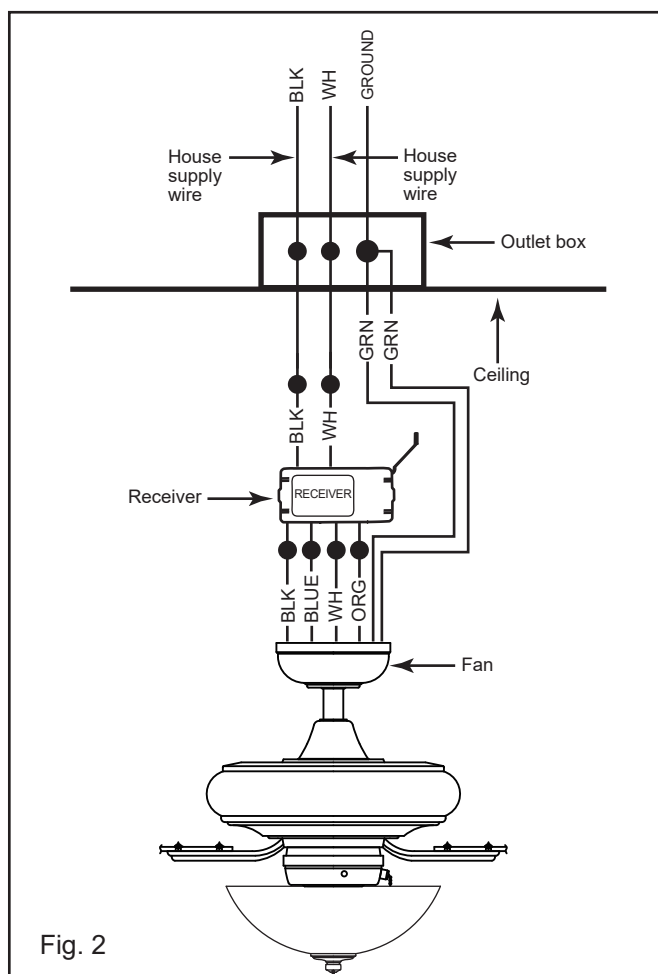
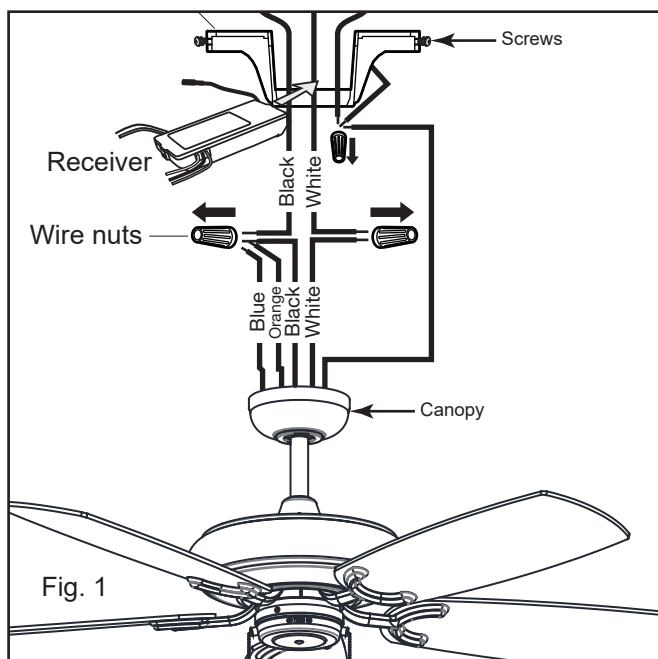

2. REMOTE PAIRING PROCESS

NOTE: This unit is equipped with an automatic learn function. There are no frequency switches on the receiver; the receiver unit will automatically scan the frequency from the remote control if any changes are made.

A. Install batteries included with the transmitter. (Fig. 3)

NOTE: To prevent damage to the transmitter, remove these batteries if not used for long periods of time (months).

B. Select the desired frequency setting from the back of the remote control transmitter. (Fig. 3) You change the frequency setting by arranging the small switches numbered 1 through 4 in the up or down position making 16 different frequencies or combinations possible. Anytime you change the frequency for a fan you must complete the pairing process as described above.

C. Restore power to the fan. Press and hold "■" button for about 5 seconds and release. If optional light kit is installed, the light kit will flash twice and the signal light on the handheld remote will come on when the button is pressed. The fan has completed the pairing process with the handheld remote and is ready for use.

D. The "O" and "D" dip switch: The "D" selection is the light dimmable selection for LED light only. The "O" selection is for light ON/OFF functionality only. (Fig. 1)

3. OPERATING TRANSMITTER:

A. Store the transmitter away from excess heat or humidity.

B. Operation buttons on the panel of the transmitter: (Fig. 4)

The "1, 2, 3, 4" buttons:

These four buttons are used to set the fan speed as follows:

1= Low speed 2= Medium speed 3= Medium High speed
4= High speed

The "■" button:

This button turns the fan off.

The "☀️☀️" button:

For fans that use LED bulbs, select "D" in the dip switch. The "☀️" button turns the upper light ON or OFF and also controls the brightness setting. The "☀️☀️" button turns the bottom light ON or OFF and also controls the brightness setting. Press and release the button to turn the light ON or OFF. Press and hold the button to set the desired brightness. The light button has an auto-resume, it will stay at the same brightness as the last time it was turned off.

The "↻" button: Switches between summer mode and winter mode fan directions.

YOUR REMOTE NOW HAS FULL CONTROL OF THE FAN AND LIGHT.

4. TROUBLESHOOTING GUIDE

A. Fails to operate:

- Power to the receiver?
- Receiver wired correctly?
- Light kit switch turned on?
- Good battery in the transmitter?

B. Won't operate at distance:

If the signal is weak and fails to operate the fan from a distance less than 30 feet, try repositioning the antenna wire inside the fan canopy for better reception.

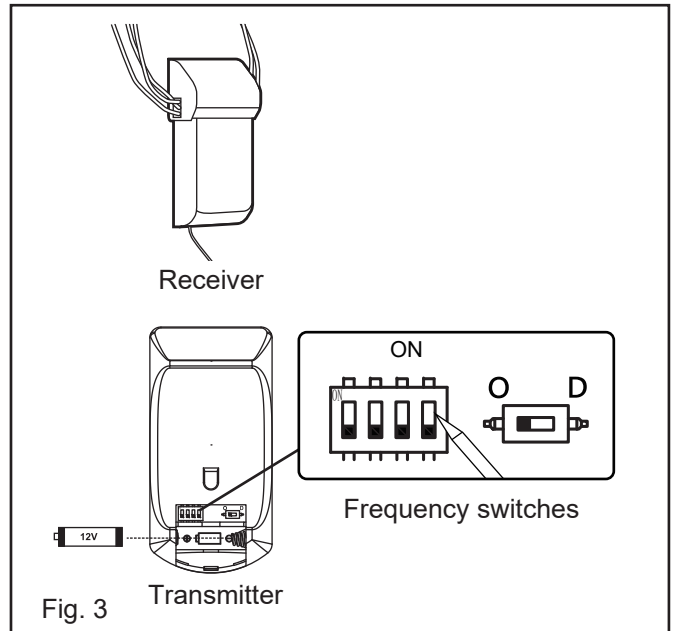

Fig. 3 Transmitter

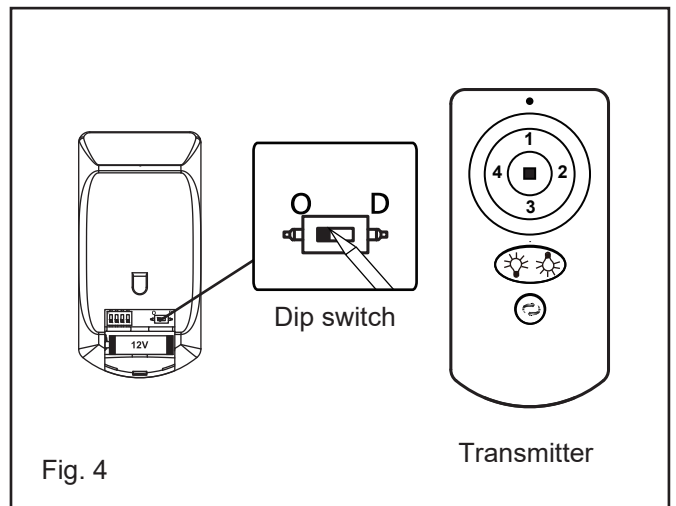

Fig. 4

Transmitter

NOTICE!

Your ceiling fan and light kit assembly must meet the following requirements:

- Do not use with solid state fans.
- Electrical rating: 120V / 60 Hz
MAX. motor amps: 1.0 A
MAX. light watts: 150 W

For Warranty Information please visit www.hinkley.com

SMART CEILING FAN WIFI REMOTE CONTROL

INSTALLATION & OPERATING INSTRUCTIONS

SMART PHONE install add device

1. Install with WIFI APP

- A. To enjoy all the potential of your new device, you will need to download the BOND HOME app, available on the Google Play Store and Apple App Store
- B. Use the QR code presented in Figure 1 to download the app, or you can download the app using below link. <http://bondhome.io/app>.



- C. After you download the app, register new account and password.

NOTE: Please keep this account property, you will use this account when you connect with you smart speaker.

- D. After you Log into the main page, you will see the ”+ ”on the right side of top space.

- E. You will see ADD a new device screen, and choose Smart by Bond. Then you could follow the config WiFi process to continue pairing.

- F. After the pairing process is complete you can control. the fan speed, light functions on the app.

2. Process to make the fan discoverable:

- A. Press and hold the "off" button for 5 seconds. The light will turn on and off to indicate discovery mode.

- B. Add a device per the instruction above.

